

THE DESIGNATION AND LOCATION ON THIS SITE PLAN OF STORE UNIT SIZES, TENANT NAMES, AND OTHER INFORMATION ABOUT THE SHOPPING CENTER, ITS BUILDINGS, AND COMMON AREAS IS NOT A REPRESENTATION BY LANDLORD THAT SUCH CONDITIONS EXIST OR WILL CONTINUE TO EXIST THROUGHOUT ALL OR ANY PORTION OF THE TERM OF TENANT'S LEASE. THIS SITE PLAN AND OTHER INFORMATION CONTAINED HEREIN IS FOR MARKETING PURPOSES ONLY, EXCEPT AS SUCH MAY BE SPECIFICALLY INDICATED OTHERWISE IN TENANT'S LEASE.

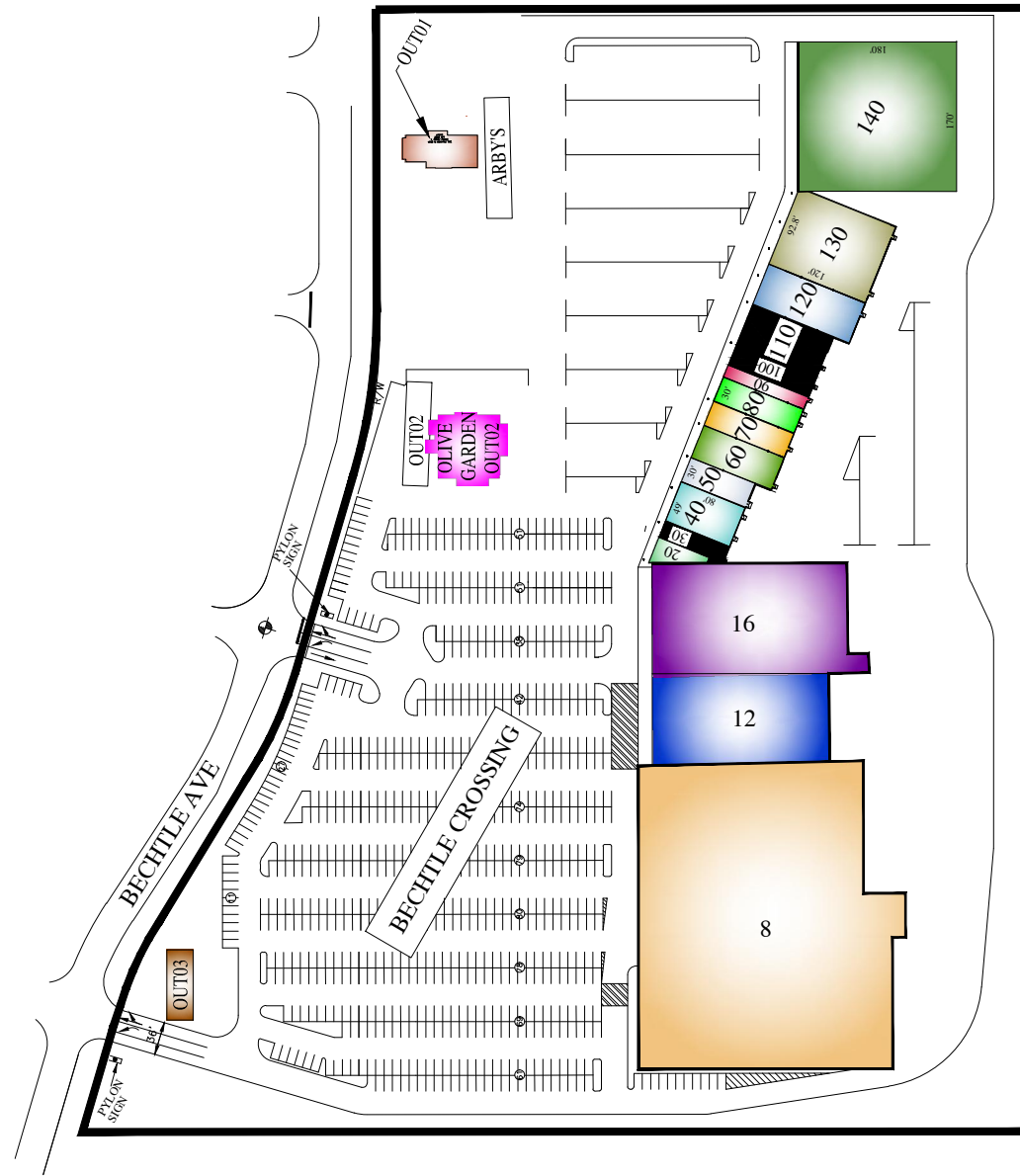

SPACE	NAME	AREA	LAYOUT
8	KOHL'S	89,003 SF	323' x 380'
12	BED, BATH&BEYOND	20,000 SF	100' x 200'
16	MARSHALLS	25,454 SF	125' x 208'
20	FIESTA	1,225 SF	-
30	AVAILABLE	1,540 SF	19' x 80'
40	AMERICA'S BEST OPTICAL	3,907 SF	49' x 80'
50	CINGULAR WIRELESS	2,400 SF	30' x 80'
60	LANE BRYANT	4,000 SF	40' x 100'
70	BANK OF AMERICA	3,000 SF	30' x 100'
80	PAYLESS SHOE	3,000 SF	30' x 100'
90	SALLY BEAUTY	1,500 SF	15' x 100'
100	AVAILABLE	2,500 SF	25' x 100'
110	AVAILABLE	5,000 SF	50' x 100'
120	FAMOUS FOOTWARE	6,000 SF	50' x 120'
130	DOLLAR TREE	11,153 SF	93' x 120'
140	ASHLEY FURNITURE	30,600 SF	170' x 180'
OUT01	ARBY'S	-	-
OUT02	OLIVE GARDEN	-	-
OUT03	PORTRAIT INNOVATIONS	2,400 SF	-



U.S. PROPERTIES GROUP, INC. 3665 FISHINGER BLVD. HILLIARD, OH 43026 LOCATION: BECHTLE CROSSING SPRINGFIELD, OH. CLARK COUNTY		
AC.	G.L.A.	DATE
24.892	210,262	7-1-11
PARKING: 796 TOTAL SPACES (771 STANDARD, 25 HANDICAP) DEVELOPED: 1995 REDEVELOPED 2006-2007		
SCALE: AS NOTED	CAD FILE NAME: SPRINGFIELD COMMONS-BECHTLE	SHEET 1 OF 1