

THE DESIGNATION AND LOCATION ON THIS SITE PLAN OF STORE UNIT SIZES, TENANT NAMES, AND OTHER INFORMATION ABOUT THE SHOPPING CENTER, ITS BUILDINGS, AND COMMON AREAS IS NOT A REPRESENTATION BY LANDLORD THAT SUCH CONDITIONS EXIST OR WILL CONTINUE TO EXIST THROUGHOUT ALL OR ANY PORTION OF THE TERM OF TENANT'S LEASE. THIS SITE PLAN AND OTHER INFORMATION CONTAINED HEREIN IS FOR MARKETING PURPOSES ONLY, EXCEPT AS SUCH MAY BE SPECIFICALLY INDICATED OTHERWISE IN TENANT'S LEASE.

SPACE	NAME	AREA	LAYOUT
10	APPLEBEE'S	4,000 SF	50' x 80'
20A	AVAILABLE	2,000 SF	25' x 40'
20B	GAMESTOP	2,000 SF	25' x 40'
30A	SHOE DEPT.	9,000 SF	
30B	DOLLAR TREE	11,000 SF	
40	RUE 21	4,975 SF	83' x 60'
50	RADIO SHACK	1,500 SF	25' x 60'
60	CIRO'S PIZZA	1,500 SF	25' x 60'

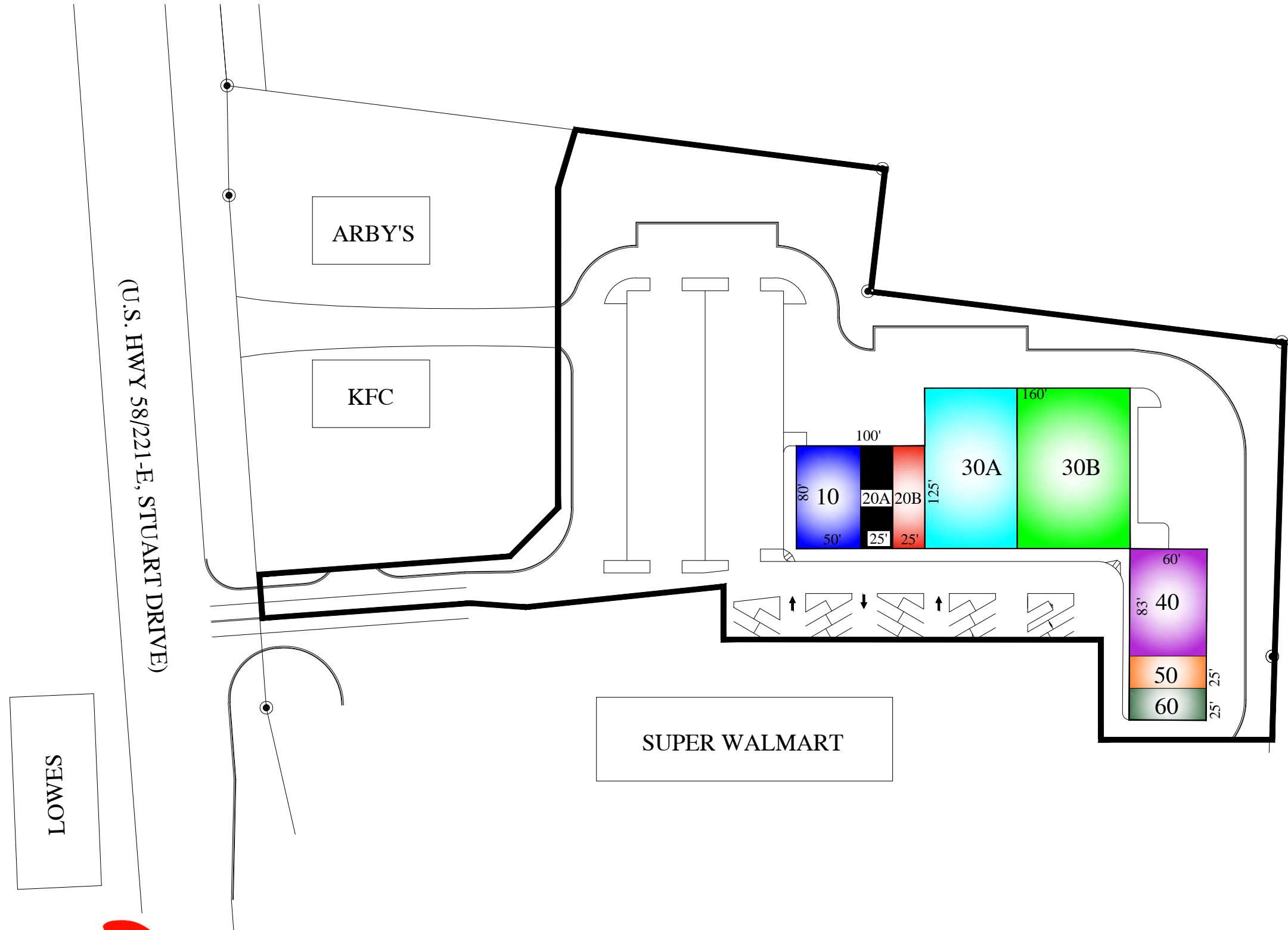

PROPOSED
SITE PLAN



U.S. PROPERTIES GROUP, INC. 3665 FISHINGER BLVD. HILLIARD, OH. 43026		
LOCATION: CHERRY HILL PLAZA GALAX, VA. CARROLL COUNTY		
AC. 4.314	G.L.A. 35,975	DATE 7-1-11
PARKING: 133 TOTAL SPACES (128 STANDARD, 5 HANDICAP)		
DEVELOPED: 1999		
SCALE: AS NOTED	CAD FILE NAME: CHERRY HILL PLAZA	SHEET 1 OF 1