

THE DESIGNATION AND LOCATION ON THIS SITE PLAN OF STORE UNIT SIZES, TENANT NAMES, AND OTHER INFORMATION ABOUT THE SHOPPING CENTER, ITS BUILDINGS, AND COMMON AREAS IS NOT A REPRESENTATION BY LANDLORD THAT SUCH CONDITIONS EXIST OR WILL CONTINUE TO EXIST THROUGHOUT ALL OR ANY PORTION OF THE TERM OF TENANT'S LEASE. THIS SITE PLAN AND OTHER INFORMATION CONTAINED HEREIN IS FOR MARKETING PURPOSES ONLY, EXCEPT AS SUCH MAY BE SPECIFICALLY INDICATED OTHERWISE IN TENANT'S LEASE.

SPACE	NAME	AREA	LAYOUT
10	DUNHAM'S	36,052 SF	-
20	GOODWILL	14,479 SF	-
601	MONROE MUFFLER	4,500 SF	50' x 90'

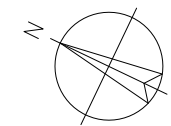
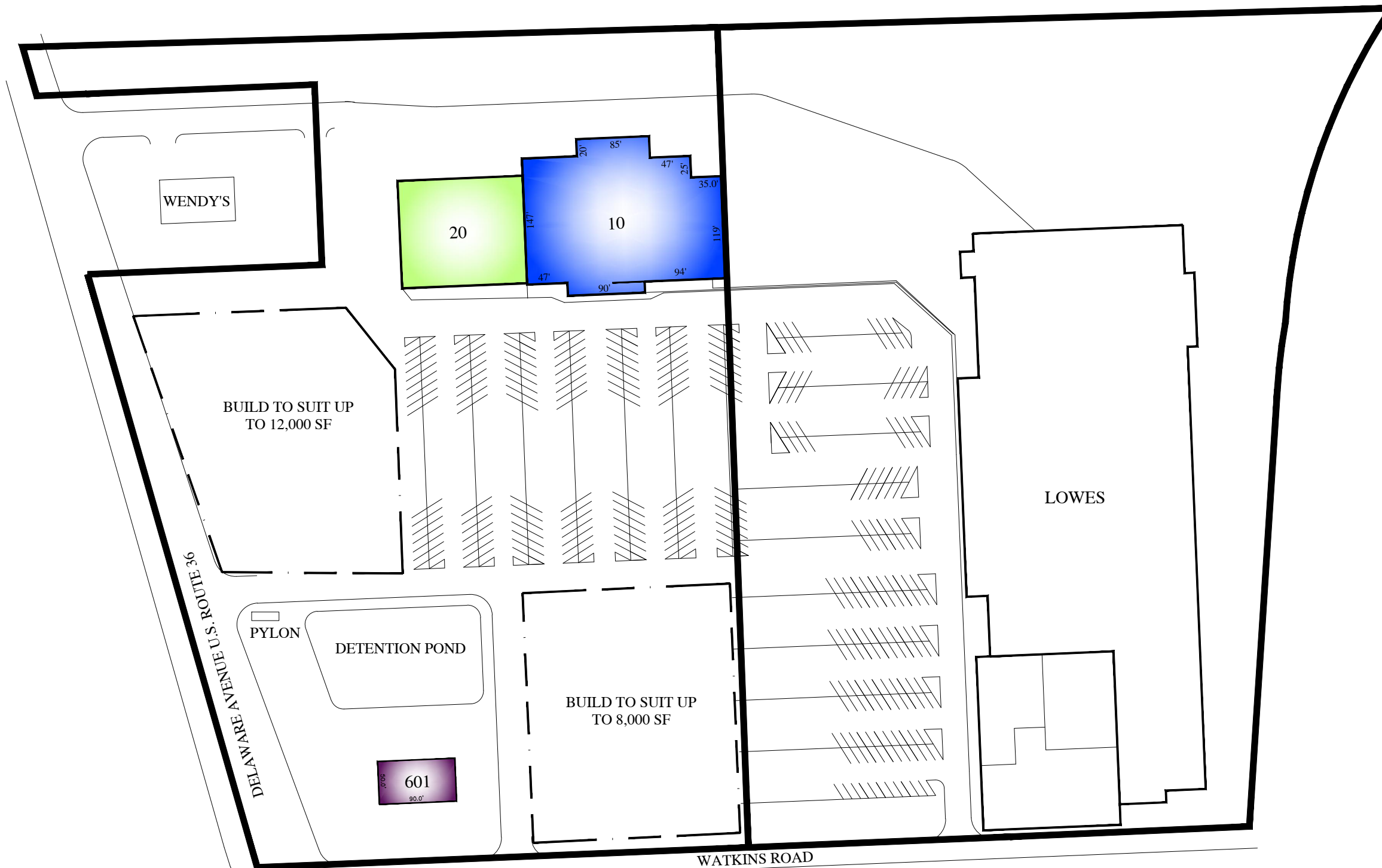

<b>U.S. PROPERTIES GROUP, INC.</b> 3665 FISHINGER BLVD. HILLIARD, OH 43026		
LOCATION: <b>EAST POINTE PLAZA</b> <b>MARYSVILLE, OH</b> <b>UNION COUNTY</b>		
AC. 25.688	G.L.A. -	DATE 7-1-11
PARKING: 915 TOTAL SPACES (893 STANDARD, 22 HANDICAP)		
DEVELOPED: 1992, REDEVELOPMENT IN PROCESS		
SCALE: AS NOTED	CAD FILE NAME: EAST POINTE PLAZA	SHEET 1 OF 1