

THE DESIGNATION AND LOCATION ON THIS SITE PLAN OF STORE UNIT SIZES, TENANT NAMES, AND OTHER INFORMATION ABOUT THE SHOPPING CENTER, ITS BUILDINGS, AND COMMON AREAS IS NOT A REPRESENTATION BY LANDLORD THAT SUCH CONDITIONS EXIST OR WILL CONTINUE TO EXIST THROUGHOUT ALL OR ANY PORTION OF THE TERM OF TENANT'S LEASE. THIS SITE PLAN AND OTHER INFORMATION CONTAINED HEREIN IS FOR MARKETING PURPOSES ONLY, EXCEPT AS SUCH MAY BE SPECIFICALLY INDICATED OTHERWISE IN TENANT'S LEASE.

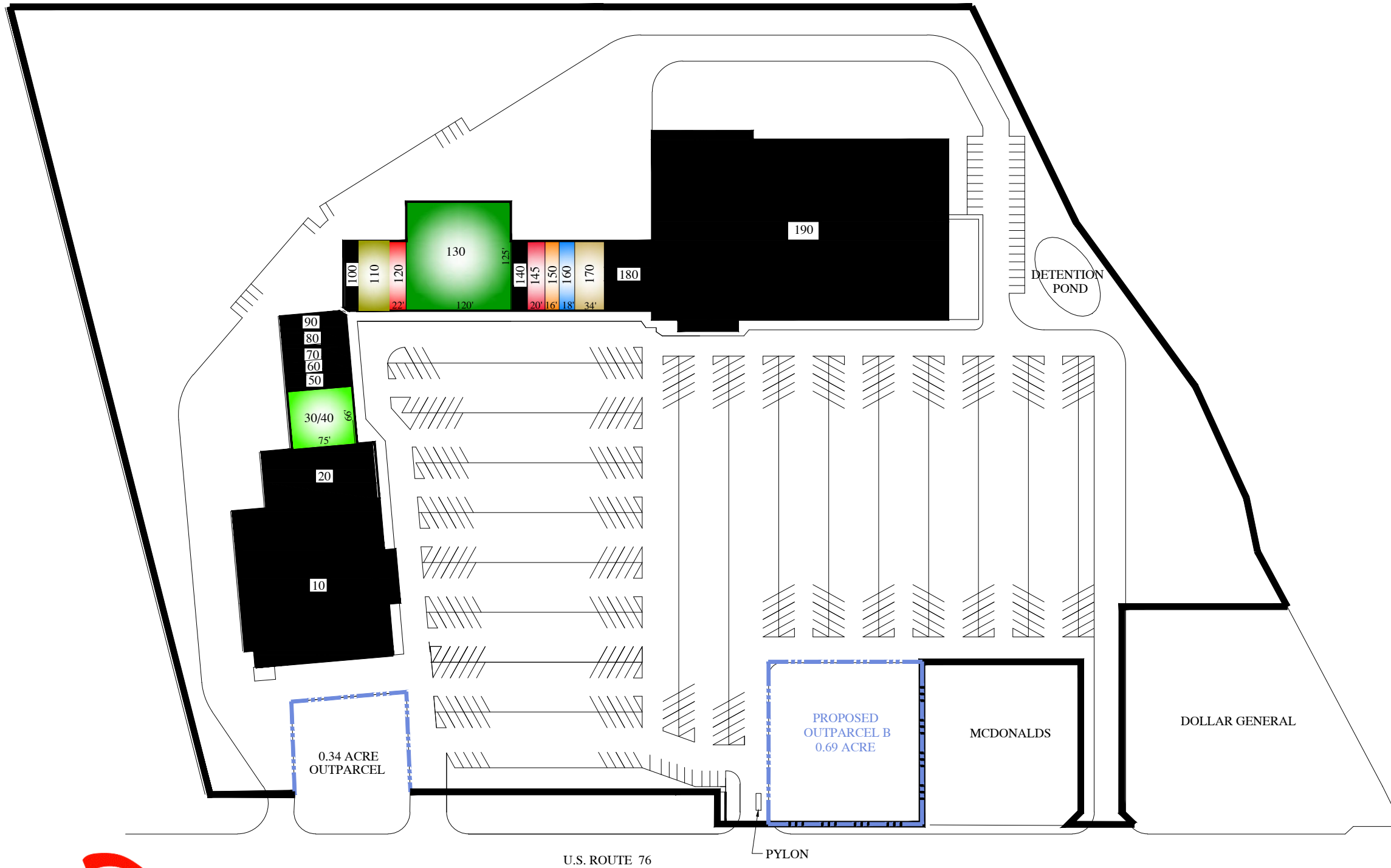

SPACE	NAME	AREA	LAYOUT
10	AVAILABLE VLO	30,800 SF	150' x 180'
20	AVAILABLE	8,450 SF	130' x 65'
30/40	HIBBETT'S	4,950 SF	66' x 75'
50	AVAILABLE	1,500 SF	20' x 75'
60	AVAILABLE	1,050 SF	14' x 75'
70	AVAILABLE	1,350 SF	18' x 75'
80	AVAILABLE	1,200 SF	16' x 75'
90	AVAILABLE	1,425 SF	19' x 75'
100	AVAILABLE	1,200 SF	15' x 80'
110	CITI FINANCIAL	2,800 SF	35' x 80'
120	AVAILABLE	1,760 SF	22' x 80'
130	PEEBLES GOODY'S	15,000 SF	120' x 125'
140	AVAILABLE	1,520 SF	-
145	BODY WORX	1,600 SF	20' x 80'
150	CHINA KING	1,300 SF	16' x 80'
160	SUBWAY	1,440 SF	18' x 80'
170	HAN'S BEAUTY SUPPLY	2,700 SF	34' x 80'
180	AVAILABLE	4,400 SF	55' x 80'
190	AVAILABLE	72,113 SF	-
B	PROPOSED OUTPARCEL		0.69 ACRES

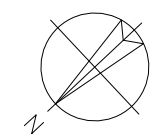

U.S. PROPERTIES GROUP, INC. 3665 FISHINGER BLVD. HILLIARD, OH. 43026		
LOCATION: MARION TOWNE CENTER MARION, S.C. MARION COUNTY		
AC. 23.800	G.L.A. 156,528	DATE 7-1-11
PARKING: 1016 TOTAL SPACES (989-REGULAR, 27 HANDICAP)		
DEVELOPED: 1992		
SCALE: AS NOTED	CAD FILE NAME: MARION TOWNE CENTER	SHEET 1 OF 1